

## SKA Weld nipple

EO 24° O-ring weld nipple / butt weld

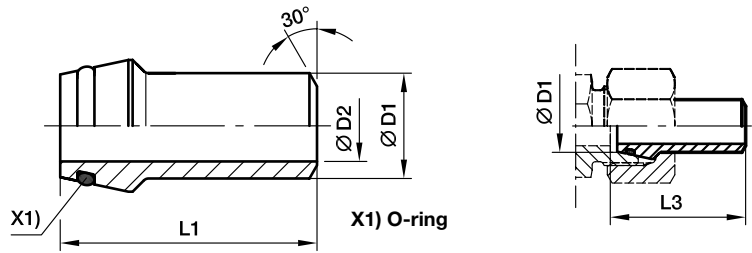

Series	D1 ⊙	D2	L1	L3	recommended tube	Weight g/1 piece	Order code	PN (bar) <sup>1)</sup>		
								Steel	Stainless Steel	
L <sup>3)</sup> /S <sup>4)</sup>	06	3.0	31.0	31.5	06×1.5	7	<b>SKA06X1.5</b>	528	539	
	08	4.5	31.0	31.5	08×1.5	11	<b>SKA08X1.5</b>	414	424	
	08	4.0	31.0	31.5	08×2.0	11	<b>SKA08X2</b>	528	539	
	10	8.0	32.5	33.5	10×1.0	13	<b>SKA10X1</b>	249	242	
	10	7.0	32.5	33.5	10×1.5	13	<b>SKA10X1.5</b>	358	349	
	10	6.0	32.5	33.5	10×2.0	16	<b>SKA10X2</b>	460	447	
	12	9.0	32.5	33.5	12×1.5	21	<b>SKA12X1.5</b>	305	297	
	12	8.0	32.5	33.5	12×2.0	20	<b>SKA12X2</b>	393	383	
	12	7.0	32.5	33.5	12×2.5	22	<b>SKA12X2.5</b>	476	463	
	L <sup>3)</sup>	15	11.0	34.0	34.5	15×2.0	29	<b>SKA15X2</b>	315	315
		15	10.0	34.0	34.5	15×2.5	31	<b>SKA15X2.5</b>	315	315
		18	13.0	35.5	36.5	18×2.5	40	<b>SKA18X2.5</b>	315	315
22		17.0	38.5	39.5	22×2.5	57	<b>SKA22X2.5</b>	160	160	
28		23.0	41.5	42.5	28×2.5	73	<b>SKA28X2.5</b>	160	160	
28		22.0	41.5	42.5	28×3.0	89	<b>SKA28X3</b>	160	160	
35		28.0	47.5	49.5	35×3.5	140	<b>SKA35X3.5</b>	160	160	
35		27.0	47.5	49.5	35×4.0	150	<b>SKA35X4</b>	160	160	
42		36.0	47.5	50.0	42×3.0	155	<b>SKA42X3</b>	160	160	
42		34.0	47.5	50.0	42×4.0	190	<b>SKA42X4</b>	160	160	
S <sup>4)</sup>		14	10.0	38.5	39.5	14×2.0	26	<b>SKA14X2</b>	343	334
		14	8.0	38.5	39.5	14×3.0	33	<b>SKA14X3</b>	487	474
	16	13.0	39.0	40.5	16×1.5	32	<b>SKA16X1.5</b>	234	228	
	16	12.0	39.0	40.5	16×2.0	31	<b>SKA16X2</b>	305	297	
	16	11.0	39.0	40.5	16×2.5	38	<b>SKA16X2.5</b>	372	362	
	16	10.0	39.0	40.5	16×3.0	41	<b>SKA16X3</b>	400	400	
	20	16.0	45.0	47.0	20×2.0	57	<b>SKA20X2</b>	249	242	
	20	15.0	45.0	47.0	20×2.5	57	<b>SKA20X2.5</b>	305	297	
	20	14.0	45.0	47.0	20×3.0	64	<b>SKA20X3</b>	358	349	
	20	13.0	45.0	47.0	20×3.5	71	<b>SKA20X3.5</b>	400	400	
	20	12.0	45.0	47.0	20×4.0	78	<b>SKA20X4</b>	400	400	
	25	19.0	49.5	53.0	25×3.0	89	<b>SKA25X3</b>	294	286	
	25	18.0	49.5	53.0	25×3.5	100	<b>SKA25X3.5</b>	337	328	
	25	17.0	49.5	53.0	25×4.0	111	<b>SKA25X4</b>	379	369	
	25	15.0	49.5	53.0	25×5.0	125	<b>SKA25X5</b>	400	400	
	30	24.0	52.0	57.0	30×3.0	113	<b>SKA30X3</b>	249	242	
	30	22.0	52.0	57.0	30×4.0	141	<b>SKA30X4</b>	323	314	
	30	20.0	52.0	57.0	30×5.0	166	<b>SKA30X5</b>	393	383	
	30	18.0	52.0	57.0	30×6.0	188	<b>SKA30X6</b>	400	400	
	38	32.0	56.5	64.0	38×3.0	163	<b>SKA38X3</b>	200	195	
	38	30.0	56.5	64.0	38×4.0	209	<b>SKA38X4</b>	261	254	
	38	28.0	56.5	64.0	38×5.0	247	<b>SKA38X5</b>	315	315	
	38	26.0	56.5	64.0	38×6.0	270	<b>SKA38X6</b>	315	315	
	38	24.0	56.5	64.0	38×7.0	270	<b>SKA38X7</b>	315	315	

<sup>1)</sup> Pressure shown = item deliverable

<sup>3)</sup> L = light series; <sup>4)</sup> S = heavy series

PN (bar)  
10 = PN (MPa)

\*Please add the **suffixes** below according to the material/surface required.

Order code suffixes			
Material	Suffix surface and material	Example	Standard sealing material (no additional suffix needed)
Steel		SKA16X2	NBR
Stainless Steel	71	SKA16X271	VIT

## SKA-ORB Weld nipple (orbital)

EO 24° O-ring weld nipple / butt weld (orbital)

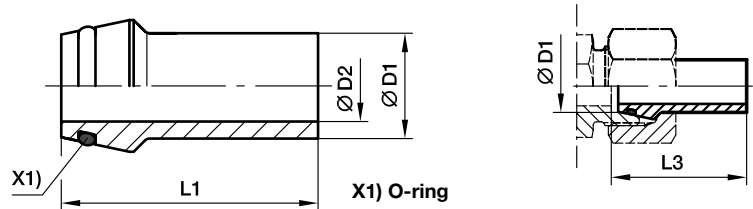

Series	D1	D2	L1	L3	recommended tube	Weight g/1 piece	Order code	PN (bar) <sup>1)</sup> Stainless Steel
L <sup>3)</sup> /S <sup>4)</sup>	10	6.0	37.5	38.5	10×1.5	13	<b>SKA10X1.5ORB</b>	358
	12	8.0	37.5	38.5	12×1.5	21	<b>SKA12X1.5ORB</b>	305
	12	8.0	37.5	38.5	12×2.0	255	<b>SKA12X2ORB</b>	393
L <sup>3)</sup>	18	13.0	38.0	39.0	18×2.0	43	<b>SKA18X2ORB</b>	290
	22	17.0	38.5	39.5	22×2.0	50	<b>SKA22X2ORB</b>	250
	28	22.0	41.5	42.5	28×2.0	69	<b>SKA28X2ORB</b>	204
	42	36.0	47.5	50.0	42×3.0	160	<b>SKA42X3ORB</b>	182
S <sup>4)</sup>	16	12.0	39.0	40.5	16×2.0	310	<b>SKA16X2ORB</b>	305
	20	14.0	45.0	47.0	20×3.0	640	<b>SKA20X3ORB</b>	358
	25	19.0	49.5	53.0	25×3.0	890	<b>SKA25X3ORB</b>	294

<sup>1)</sup> Pressure shown = item deliverable

<sup>3)</sup> L = light series; <sup>4)</sup> S = heavy series

$$\frac{\text{PN (bar)}}{10} = \text{PN (MPa)}$$

\*Please add the **suffixes** below according to the material/surface required.

Order code suffixes			
Material	Suffix surface and material	Example	Standard sealing material (no additional suffix needed)
Stainless Steel	71	SKA16X2ORB71	VIT