

ONE-TOUCH FITTINGS

> METRIC SYSTEM

PLF female elbow

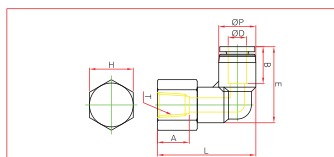

MODEL	ØD	ØP	T (Thread)	L	E	A	B	H (Hex)	ORIFICE
PLF 04-01	4	11	R1/8	24.8	24	8.0	15	14	2.5
PLF 04-02	4	11	R1/4	26.8	24	10.0	15	17	2.5
PLF 04-M5	4	11	M5 × P0.8	23.8	24	7.0	15	10	2.5
PLF 04-M6	4	11	M6 × P0.8	23.8	24	7.0	15	10	2.5
PLF 06-01	6	13	R1/8	30.8	25.2	8.0	15	14	4
PLF 06-02	6	13	R1/4	32.8	25.2	10.0	15	17	4
PLF 06-03	6	13	R3/8	33.8	25.2	11.0	15	22	4
PLF 06-04	6	13	R1/2	35.8	25.2	14.0	15	24	4
PLF 06-M5	6	13	M5 × P0.8	29.8	25.2	7.0	15	12	4
PLF 06-M6	6	13	M6 × P0.8	29.8	25.2	7.0	15	12	4
PLF 08-01	8	14.4	R1/8	33.2	30.5	8.0	18	14	6
PLF 08-02	8	14.4	R1/4	35.2	30.5	10.0	18	17	6
PLF 08-03	8	14.4	R3/8	36.2	30.5	11.0	18	22	6
PLF 08-04	8	14.4	R1/2	38.2	30.5	14.0	18	24	6
PLF 10-01	10	18.4	R1/8	37.3	37.4	8.0	22	17	7
PLF 10-02	10	18.4	R1/4	37.3	37.4	10.0	22	17	7
PLF 10-03	10	18.4	R3/8	38.3	37.4	11.0	22	22	7
PLF 10-04	10	18.4	R1/2	40.3	37.4	14.0	22	24	7
PLF 12-02	12	21	R1/4	41.7	40.4	10.0	22	19	10
PLF 12-03	12	21	R3/8	42.7	40.4	11.0	22	22	10
PLF 12-04	12	21	R1/2	44.7	40.4	14.0	22	24	10

ONE-TOUCH FITTINGS

> INCH SYSTEM

PLF female elbow

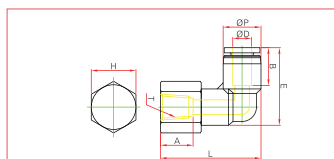

MODEL	ØD	ØP	Thread	L	E	A	B	H	ORIFICE
PLF 5/32-UNF	5/32	11	UNF 10/32	21.5	24	7.0	15	7/16	2.5
PLF 5/32-N01	5/32	11	NPT 1/8	22.5	24	8.5	15	9/16	2.5
PLF 5/32-N02	5/32	11	NPT 1/4	22.5	24	10.5	15	11/16	2.5
PLF 3/16-UNF	3/16	13	UNF 10/32	20.5	25.2	7.0	15	7/16	2.5
PLF 3/16-N01	3/16	13	NPT 1/8	22.5	25.2	8.5	15	9/16	2.5
PLF 3/16-N02	3/16	13	UNF 1/4	25.5	25.2	10.5	15	11/16	2.5
PLF 1/4-UNF	1/4	13	UNF 10/32	21	25.2	7.0	15	1/2	3
PLF 1/4-N01	1/4	13	NPT 1/8	25	25.2	8.5	15	9/16	4
PLF 1/4-N02	1/4	13	NPT 1/4	27	25.2	10.0	15	11/16	4
PLF 1/4-N03	1/4	13	NPT 3/8	26	25.2	11.5	15	7/8	4
PLF 5/16-N01	5/16	14.4	NPT 1/8	25.9	30.5	8.5	16	9/16	6
PLF 5/16-N02	5/16	14.4	NPT 1/4	27.9	30.5	10.5	16	11/16	6
PLF 5/16-N03	5/16	14.4	NPT 3/8	28.9	30.5	11.5	16	7/8	6
PLF 3/8-N02	3/8	18.4	NPT 1/4	28.5	37.4	10.5	22	11/16	7
PLF 3/8-N03	3/8	18.4	NPT 3/8	29.5	37.4	11.5	22	7/8	7
PLF 3/8-N04	3/8	18.4	NPT 1/2	33	37.4	14.5	22	15/16	7
PLF 1/2-N03	1/2	21	NPT 3/8	33	40.4	11.5	22	7/8	9
PLF 1/2-N04	1/2	21	NPT 1/2	36.5	40.4	14.5	22	15/16	9