

ONE-TOUCH FITTINGS

> METRIC SYSTEM

PL male elbow

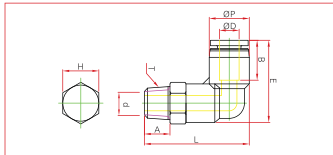

| MODEL | ØD | T (Thread) | E | L | A | B | H | ØP | d | ORIFICE |
|----------|----|---------------|------|------|----|----|----|------|------|---------|
| PL 04-01 | 4 | PT1/8 | 24 | 29.7 | 8 | 15 | 10 | 11 | 6.5 | 2.5 |
| PL 04-02 | 4 | PT1/4 | 26.3 | 32.7 | 10 | 15 | 14 | 11 | 8.7 | 2.5 |
| PL 04-03 | 4 | PT3/8 | 28 | 34 | 11 | 15 | 17 | 11 | 1.7 | 2.5 |
| PL 04-M5 | 4 | M5×P0.8 | 24 | 26.5 | 4 | 15 | 10 | 11 | 2.5 | 2.5 |
| PL 04-M6 | 4 | M6×P1.0 | 24 | 27 | 4 | 15 | 10 | 11 | 2.5 | 2.5 |
| PL 06-01 | 6 | PT1/8 | 25.2 | 30.9 | 8 | 15 | 12 | 13 | 6.5 | 2.5 |
| PL 06-02 | 6 | PT1/4 | 26.9 | 33.9 | 10 | 15 | 14 | 13 | 8.5 | 4 |
| PL 06-03 | 6 | PT3/8 | 28.6 | 35.2 | 11 | 15 | 17 | 13 | 11.2 | 4 |
| PL 06-04 | 6 | PT1/2 | 30.9 | 38.7 | 14 | 15 | 21 | 13 | 14 | 4.5 |
| PL 06-M5 | 6 | M5×P0.8 | 25.2 | 38.2 | 4 | 15 | 12 | 13 | 2.5 | 2.5 |
| PL 06-M6 | 6 | M6×P1.0 | 25.2 | 28.7 | 5 | 15 | 12 | 13 | 2.5 | 2.5 |
| PL 08-01 | 8 | PT1/8 | 30.5 | 35.4 | 8 | 18 | 14 | 14.4 | 6.8 | 4 |
| PL 08-02 | 8 | PT1/4 | 30.5 | 37.4 | 10 | 18 | 14 | 14.4 | 8.2 | 4 |
| PL 08-03 | 8 | PT3/8 | 32.2 | 38.7 | 11 | 18 | 17 | 14.4 | 11.9 | 4 |
| PL 08-04 | 8 | PT1/2 | 34.5 | 42.2 | 14 | 18 | 21 | 14.4 | 13.9 | 4 |
| PL 10-01 | 10 | PT1/8 | 37.4 | 42 | 8 | 22 | 17 | 18.4 | 6.5 | 6.5 |
| PL 10-02 | 10 | PT1/4 | 37.4 | 44 | 10 | 22 | 17 | 18.4 | 8.3 | 6.5 |
| PL 10-03 | 10 | PT3/4 | 37.4 | 45 | 11 | 22 | 17 | 18.4 | 11.7 | 6.5 |
| PL 10-04 | 10 | PT1/2 | 39.7 | 48.5 | 14 | 22 | 21 | 18.4 | 14.3 | 7.5 |
| PL 12-01 | 12 | PT1/8 | 40.4 | 44.5 | 8 | 22 | 19 | 21 | 6.5 | 6.5 |
| PL 12-02 | 12 | PT1/4 | 40.4 | 46.5 | 10 | 22 | 19 | 21 | 8 | 6.5 |
| PL 12-03 | 12 | PT3/8 | 40.4 | 48.5 | 11 | 22 | 19 | 21 | 11.5 | 7 |
| PL 12-04 | 12 | PT1/2 | 41.5 | 51 | 14 | 22 | 21 | 21 | 14 | 7.5 |
| PL 16-03 | 16 | PT3/8 | 46.2 | 57.5 | 11 | 24 | 24 | 26 | 11 | 11 |
| PL 16-04 | 16 | PT1/2 | 46.2 | 60.5 | 14 | 24 | 24 | 26 | 14 | 14 |

ONE-TOUCH FITTINGS

> INCH SYSTEM

PL male elbow

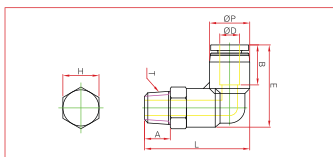

| MODEL | ØD | ØP | T (Thread) | L | E | A | B | H | ORIFICE |
|-------------|------|------|---------------|------|------|------|----|-------|---------|
| PL 5/32-UNF | 5/32 | 11 | UNF10/32 | 26.7 | 23.7 | 3.6 | 15 | 7/16 | 2.5 |
| PL 5/32-N01 | 5/32 | 11 | NPT1/8 | 30.3 | 23.7 | 8.5 | 15 | 7/16 | 3.3 |
| PL 5/32-N02 | 5/32 | 11 | NPT1/4 | 33.3 | 23.7 | 10.5 | 15 | 9/16 | 3.3 |
| PL 3/16-UNF | 3/16 | 13 | UNF10/32 | 27.2 | 24.2 | 3.6 | 15 | 7/16 | 3.3 |
| PL 3/16-N01 | 3/16 | 13 | NPT1/8 | 30.8 | 24.2 | 8.5 | 15 | 7/16 | 3.3 |
| PL 3/16-N02 | 3/16 | 13 | NPT1/4 | 33.8 | 24.2 | 10.5 | 15 | 9/16 | 3.3 |
| PL 3/16-N03 | 3/16 | 13 | NPT3/8 | 34.8 | 24.2 | 11.5 | 15 | 11/16 | 3.3 |
| PL 1/4-UNF | 1/4 | 13 | UNF10/32 | 32.4 | 26.5 | 3.6 | 15 | 1/2 | 2.5 |
| PL 1/4-N01 | 1/4 | 13 | NPT1/8 | 34.3 | 26.5 | 8.5 | 15 | 1/2 | 4.5 |
| PL 1/4-N02 | 1/4 | 13 | NPT1/4 | 37 | 26.5 | 10.5 | 15 | 9/16 | 4.5 |
| PL 1/4-N03 | 1/4 | 13 | NPT3/8 | 38 | 26.5 | 11.5 | 15 | 11/16 | 4.5 |
| PL 5/16-N01 | 5/16 | 14.4 | NPT1/8 | 36.7 | 30.1 | 8.5 | 18 | 9/16 | 6.6 |
| PL 5/16-N02 | 5/16 | 14.4 | NPT1/4 | 38.7 | 30.1 | 10.5 | 18 | 9/16 | 6.6 |
| PL 5/16-N03 | 5/16 | 14.4 | NPT3/8 | 39.7 | 30.1 | 11.5 | 18 | 11/16 | 6.6 |
| PL 5/16-N04 | 5/16 | 14.4 | NPT1/2 | 42.7 | 30.1 | 14.5 | 18 | 7/8 | 6.6 |
| PL 3/8-N01 | 3/8 | 18.4 | NPT1/8 | 38.8 | 32.3 | 8.5 | 22 | 11/16 | 5.5 |
| PL 3/8-N02 | 3/8 | 18.4 | NPT1/4 | 40.8 | 32.3 | 10.5 | 22 | 11/16 | 7.7 |
| PL 3/8-N03 | 3/8 | 18.4 | NPT3/8 | 41.8 | 32.3 | 11.5 | 22 | 11/16 | 7.7 |
| PL 3/8-N04 | 3/8 | 18.4 | NPT1/2 | 44.8 | 32.3 | 14.5 | 22 | 7/8 | 7.7 |
| PL 1/2-N02 | 1/2 | 21 | NPT1/4 | 46 | 37.8 | 10.5 | 22 | 3/4 | 8.8 |
| PL 1/2-N03 | 1/2 | 21 | NPT3/8 | 47 | 37.8 | 11.5 | 22 | 3/4 | 9.9 |
| PL 1/2-N04 | 1/2 | 21 | NPT1/2 | 50 | 37.8 | 14.5 | 22 | 7/8 | 9.9 |